

## 2020 IPANEMA 58 SAILING CAT "SEA'D MONEY"

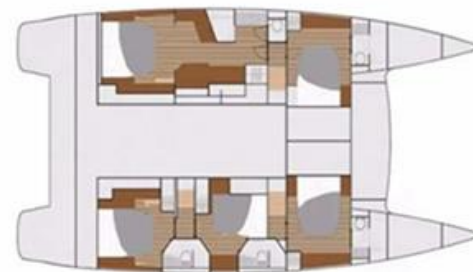

Designed to comfortably share simple day trips or long-haul cruises with family or friends, the **Ipanema 58** features a myriad of decadent and spacious areas in which to relax. Host long lazy lunches in the stunning 25m<sup>2</sup> cockpit that comfortably accommodates the largest group of guests, and then unwind on the inspired modular sunbathing deck on the catamaran's expansive foredeck. This cruising catamaran includes a large flybridge, with dual access points to deliver safe and convenient movement onboard.

- Year: 2020
- Length: 58 feet
- Accommodates 10 guests
- 5 Queen Cabins & 1 crew cabin
- 5 Electric heads
- Convertible settee in salon
- 110V sockets in cabins, 110V and 200V in galley
- **Air conditioning**
- **Watermaker**
- **Generator 17KW 220V 60Hz**
- Yanmar 4JH THE **110hp Deisel**
- **Hydraulic platform for tender**
- Second VHF AIS at helm station
- Fly bridge audio speakers

- Garmin 3 Smart Cruising pilot VHF  
AIS 2 x GPS 7412
- 2 x additional AGM batteries
- Microwave oven 220V
- **Dishwasher (full size)**
- Mechanical ventilation in all cabins
- **Ice maker**

This visionary yacht will seduce you with its luxuriously appointed interior, contemporary fixtures, and choice of innovative layouts, including an epicurean galley connected to the spacious saloon.

With its unrivalled living space, intelligent design and dynamic performance, the Ipanema 58 delivers a luxury cruising experience





## What's Included in your charter:

- Linens and towels
- Fully equipped galley
- BBQ grill
- Navigation charts and manual navigation tools
- First aid kit, life preservers and emergency equipment
- Starter kit: Dish soap, toilet paper, 1 roll paper towels, trash bags, spice kit





**Location:**

Connanicut Marina, Jamestown MA

**Weekly Rate**

\$21,000 **Captain only** (rate includes captain)

Add \$300/day for Chef